

USFWS Information for Planning and Consultation

Biological Resources / Threatened and Endangered Species

[US Fish and Wildlife IPaC Website](#)

1. Open the Information for Planning and Consultation and select **Get Started**.
2. There are two options to upload the project area: **Find location** or **Define area**.

Find location

- Under **Find location**, enter the project location in the search bar or select **Upload Geometry** if you have an applicable shapefile for the project area.

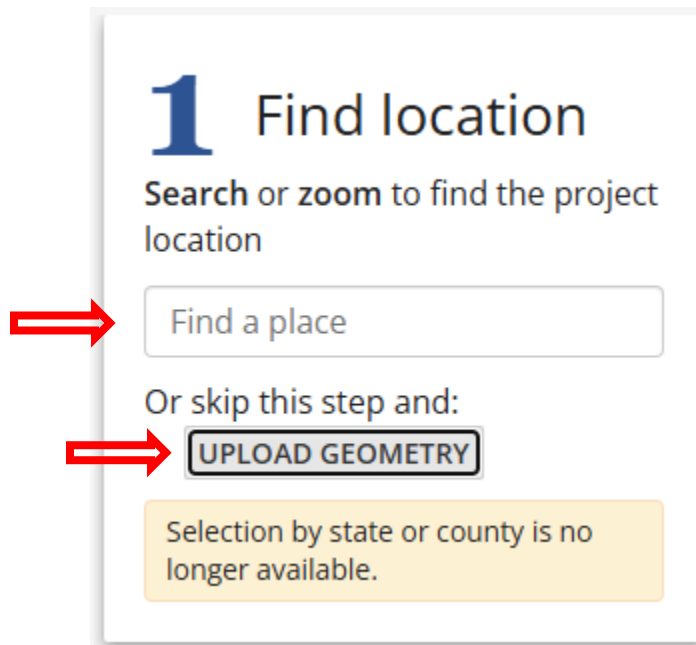

Define area

- Under **Define area**, zoom to the general area of the project on the map. Select one of the tools (**Sketch**, **Polygon**, or **Line**) then draw in the project area, or select **Upload Geometry** if you have an applicable shapefile for the project area.

2 Define area

Draw the area where activities will occur

Select a drawing tool



SKETCH



POLYGON



LINE

Other options:

UPLOAD GEOMETRY

Selection by state or county is no longer available.

3. After specifying the project area, select **Continue** under **Confirm**.

3 Confirm

Verify the area where project activities will occur

Modify the shape by clicking and dragging the vertices or clicking on a solid vertex to remove it

AREA: 353.15 acres

CONTINUE

START OVER

4. This will take you to a new page. On this page, select **Print Resource List** on the left side of the screen.

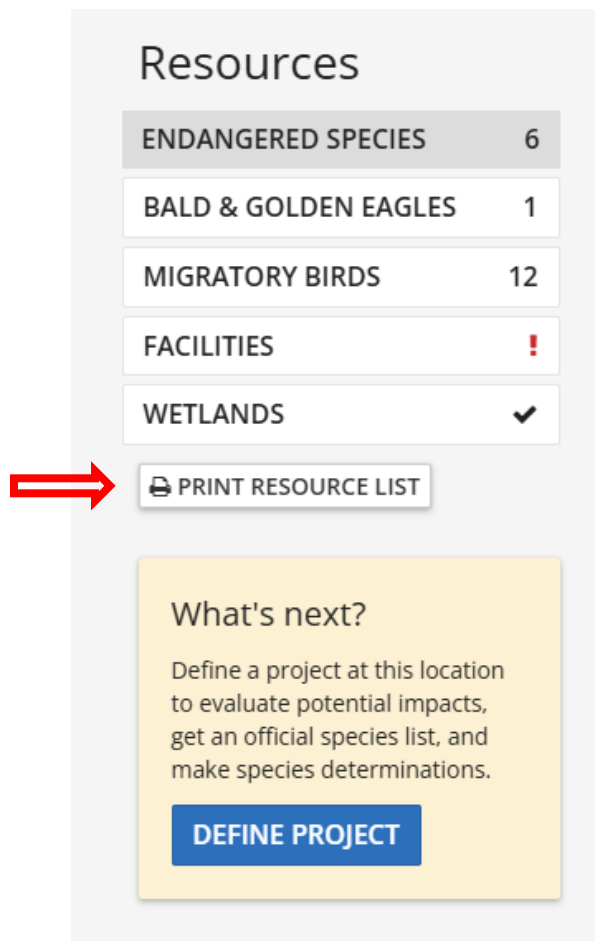

The screenshot shows a web interface titled "Resources". It features a list of resource categories with their respective counts:

Resource Category	Count
ENDANGERED SPECIES	6
BALD & GOLDEN EAGLES	1
MIGRATORY BIRDS	12
FACILITIES	!
WETLANDS	✓

Below the list is a button labeled "PRINT RESOURCE LIST" with a printer icon, which is highlighted by a red arrow. Underneath the button is a yellow box titled "What's next?" containing the text: "Define a project at this location to evaluate potential impacts, get an official species list, and make species determinations." and a blue button labeled "DEFINE PROJECT".

4. This will produce a pop-up. On this pop-up select **I'm Printing This Page For Other Purposes**.

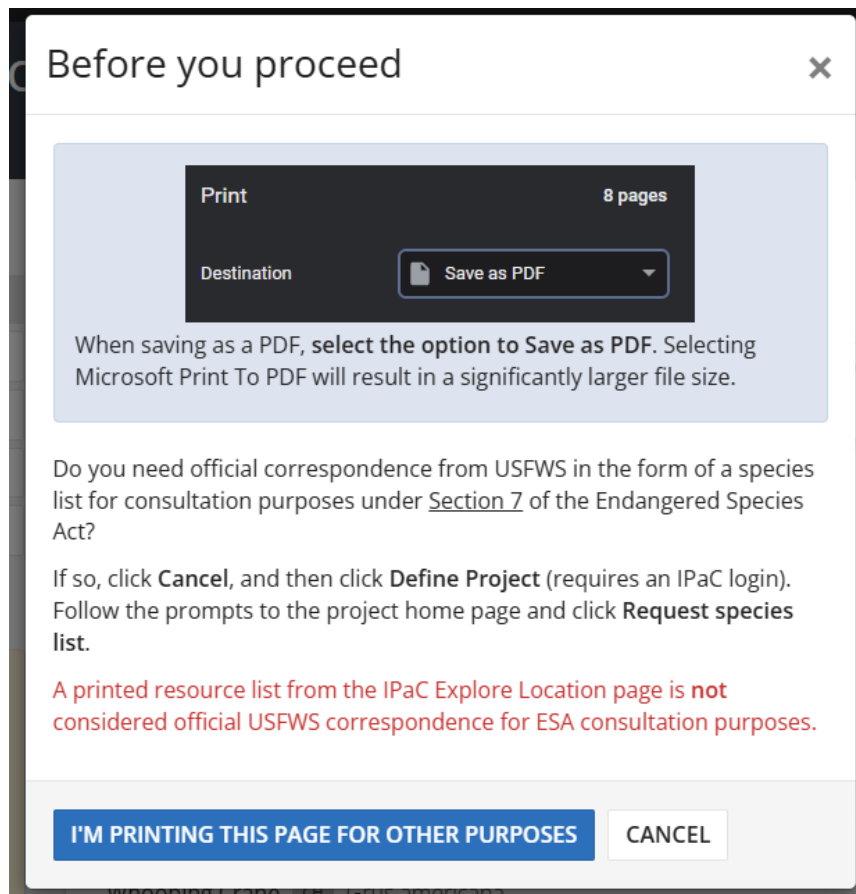

5. This will allow you to save the document as a PDF in your desired folder.

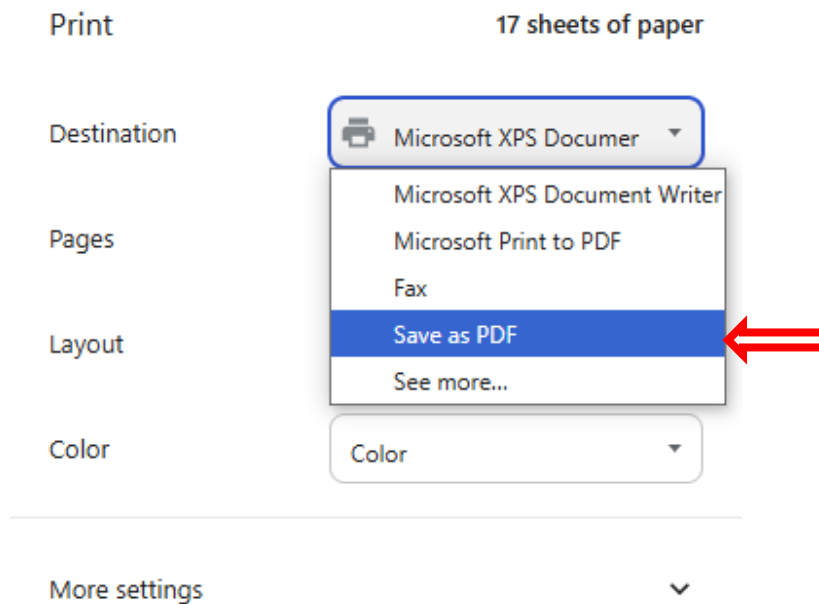

Please note that links were current as of the date of public posting of this document, but may have changed.

Neither the State of Nebraska, the Nebraska Broadband Office, any employee or officer of either entity, nor any consultants working on their behalf, makes any representation or warranty regarding the accuracy or completeness of the information contained herein. It is the sole responsibility of applicant to comply with all requirements of the Nebraska Broadband Equity, Access, and Deployment (NBEAD) Program, including, but not limited to, compliance with applicable laws and regulations. Any applicant or party relying on this guidance should conduct their own research and hire their own professional consultants, advisers, and attorneys.